

**General Arrangement**

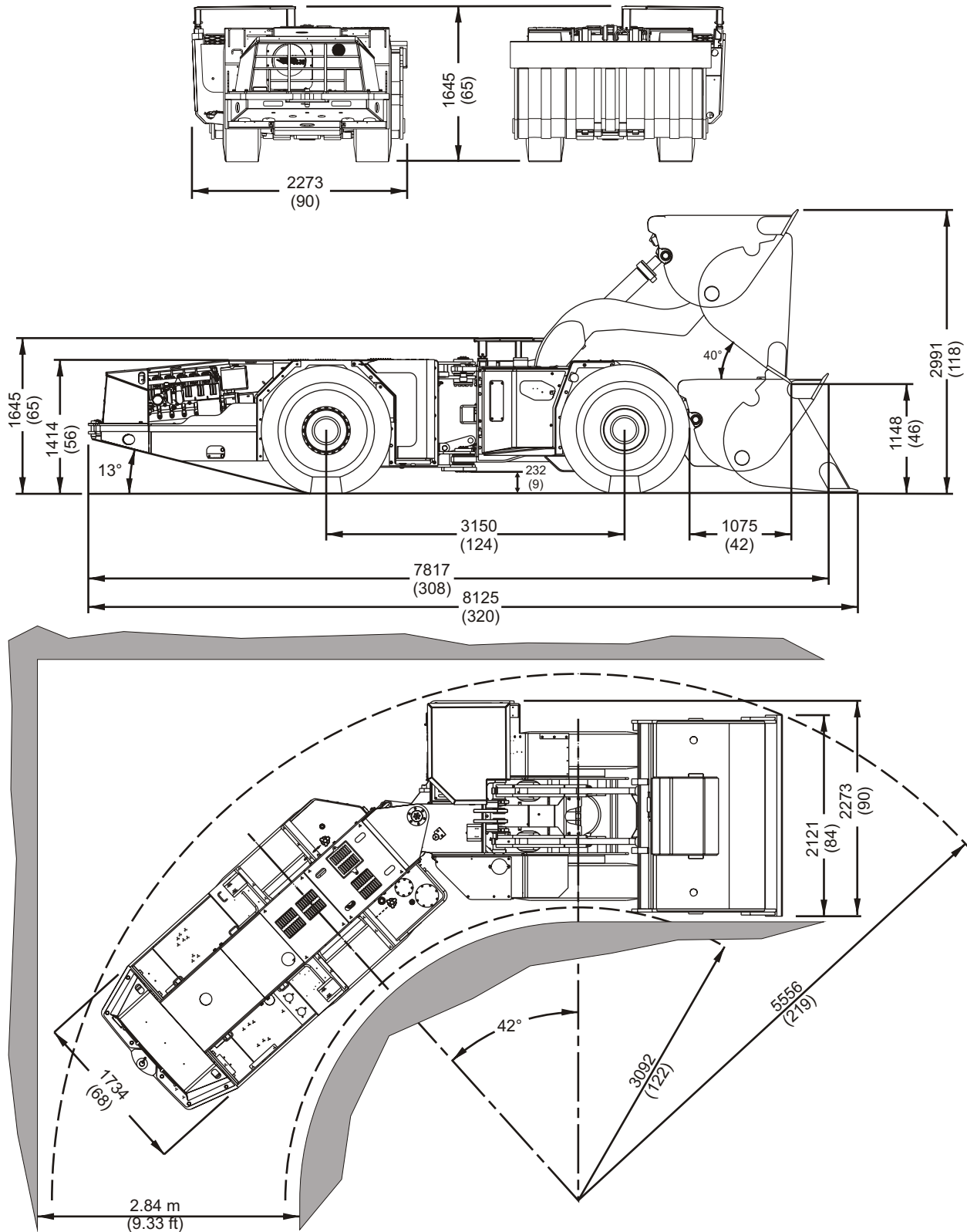

## Standard Unit Specifications

### General Information

#### Main Dimensions

Total length	7817 mm	308 in
Maximum width	2273 mm	89.5 in
Height without canopy	1414 mm	56 in
Standard operating height	1.6 m	5.25 ft

#### Operating Weights

Total operating weight	15658 kg	34520 lb.
front axle	6688 kg	14744 lb.
rear axle	8970 kg	19776 lb.

#### Loaded Weights

Total loaded weight	21158 kg	46645 lb.
front axle	14686 kg	32377 lb.
rear axle	6472 kg	14268 lb.

#### Capacities

Tramming capacity	5500 kg	12125 lb.
Break out force, lift	61.4 kN	13800 lbf
Break out force, tilt	93 kN	20900 lbf
Tipping load	15890 kg	35000 lb.
Standard Bucket	2.3 m <sup>3</sup>	3.0 yd <sup>3</sup>

#### Bucket Motion Times

Raising time	4.5 sec.
Lowering time	3.0 sec.
Dumping time	4.0 sec.

#### Driving Speeds Forward and Reverse (Loaded)

1st gear	4.1 km/h	2.5 m.p.h.
2nd gear	8.1 km/h	5.0 m.p.h.
3rd gear	11.4 km/h	7.0 m.p.h.
4th gear	21.4 km/h	13.3 m.p.h.

#### Frame

Rear and front frame	Welded steel box construction
Material	G40.21 - 50wt Cat.3
Central hinge	Welded steel box construction with hardened steel spherical bearings
Material	G40.21 - 50wt Cat.3

### Power Train

#### Engine

Diesel engine	Deutz BF4M-2012C Tier II	
Output	89.5 kW (120 Hp) @ 2500 rpm	
Torque	428 Nm (316 lbf-ft) @ 1500 rpm	
Number of cylinders	4	
Displacement	4.04 l (246.5 in <sup>3</sup> )	
Cooling system	Liquid cooled	
Combustion principle	Turbo charged, direct injected	
Air filtration	Donaldson, dry type	
Electric system	24 V	
Exhaust purification	ECS catalytic purifier	
Fuel Tank Capacity	132 l	35 US gal.

#### Converter

Dana SOH C 272	Single stage, stall torque ratio: 2.87:1, Offset Ratio: 0.96:1
----------------	--

#### Transmission

Dana SOH R32421	4-speed forward and reverse with modulation
-----------------	---

#### Axles

Front axle	Dana SOH 14D2149, No-Spin differential, fixed.
Rear axle	Dana SOH 14D2149, No-Spin differential, oscillating $\pm 5^\circ$ .

#### Tires

Tire size	14:00 X 24, 20 PLY L5S		
Air pressure, front	552 kPa	5.52 bar	80 psi
Air pressure, rear	552 kPa	5.52 bar	80 psi

## Systems

### Steering Hydraulics

Full hydraulic power steering, centre articulated with one double acting steer cylinder, open centre system with gear pump. Equipped with pilot operated control stick.

### Turning Radius

inner	3092 mm	122 in
outer	5556 mm	219 in

### Main Components

Hydraulic pump	Gear pump
Control valve	Parker
Steering cylinders	EJC 125 mm bore x 70 mm rod

### Pressure Settings

Main relief	16.5 MPa	165 bar	2400 psi
Port relief valves	15.2 MPa	152 bar	2200 psi

### Bucket Hydraulics

Full hydraulic open-centre system with one gear pump. Equipped with pilot operated joystick control lever.

### Main Components

Lift cylinders	EJC 160 mm bore x 90 mm rod
Dump Cylinder	EJC 160 mm bore x 90 mm rod
Hydraulic pump	Gear Pump
Control valve	Parker

### Pressure Settings

Main relief	16.5 MPa	165 bar	2400 psi
Bucket dump	6.9 MPa	69 bar	1000 psi
Bucket roll back	18.3 MPa	183 bar	2650 psi
Lift arms raise	18.3 MPa	183 bar	2650 psi
Lift arms lower	6.9 MPa	69 bar	1000 psi
Hyd. oil tank capacity	189 l	50 US gal.	

### Standard Brakes

Service brakes are spring applied / hydraulically released, liquid cooled multi-disc brakes on all wheels. Service brakes also function as an emergency brake when the emergency brake system is engaged.

### Main Components

Pressure accumulator	Piston type with charge valve
Brake pedal valve	Modulated

### Electrical Equipment

Alternator	24 V 35 A min.
Batteries	2 x 12 V, 950 CCA, ___ Ah
Starter	24 V Heavy Duty
Driving and working lights	2 front, 2 rear

### Other Standard Equipment

- Electric indicator/warning lights
- Hydraulic transmission shift controls
- Audible back-up alarm
- Central hydraulic pressure test points
- Central manual lubrication system
- SAE JIC hose fittings

### Manuals

All manuals are delivered on CD-ROM in web based format with Adobe PDF output for printing.

### Distribution

Manual Type	Customer	Market Area
Spare parts manuals	3 Copies	1 Copy
Operator's manual	3 Copies	1 Copy
Service manual	3 Copies	1 Copy

## Optional Equipment Specifications

### Available Alternative Equipment

Auto lube system	Lincoln modular
Tires	12.00 X 24, 20 ply L5S Tires

### Alternative Bucket Options

Ejector Buckets	Volume	Width
	2.0 m <sup>3</sup> 2.6 yd <sup>3</sup>	2100 mm    83 in

### Available Add-On Options

Quick disconnect system (QDS) - master hitch		
QDS bucket	2.3 m <sup>3</sup>	3.0 yd <sup>3</sup>
QDS pallet forks		
QDS dozer blade		
FOPS canopy, bolt on, maximum height 1.6 m		
Dual camera closed circuit video monitor system		
Stitch weld option		
Hand held fire extinguisher - 10 lb.		

## Tractive Effort Curve (Metric Units)

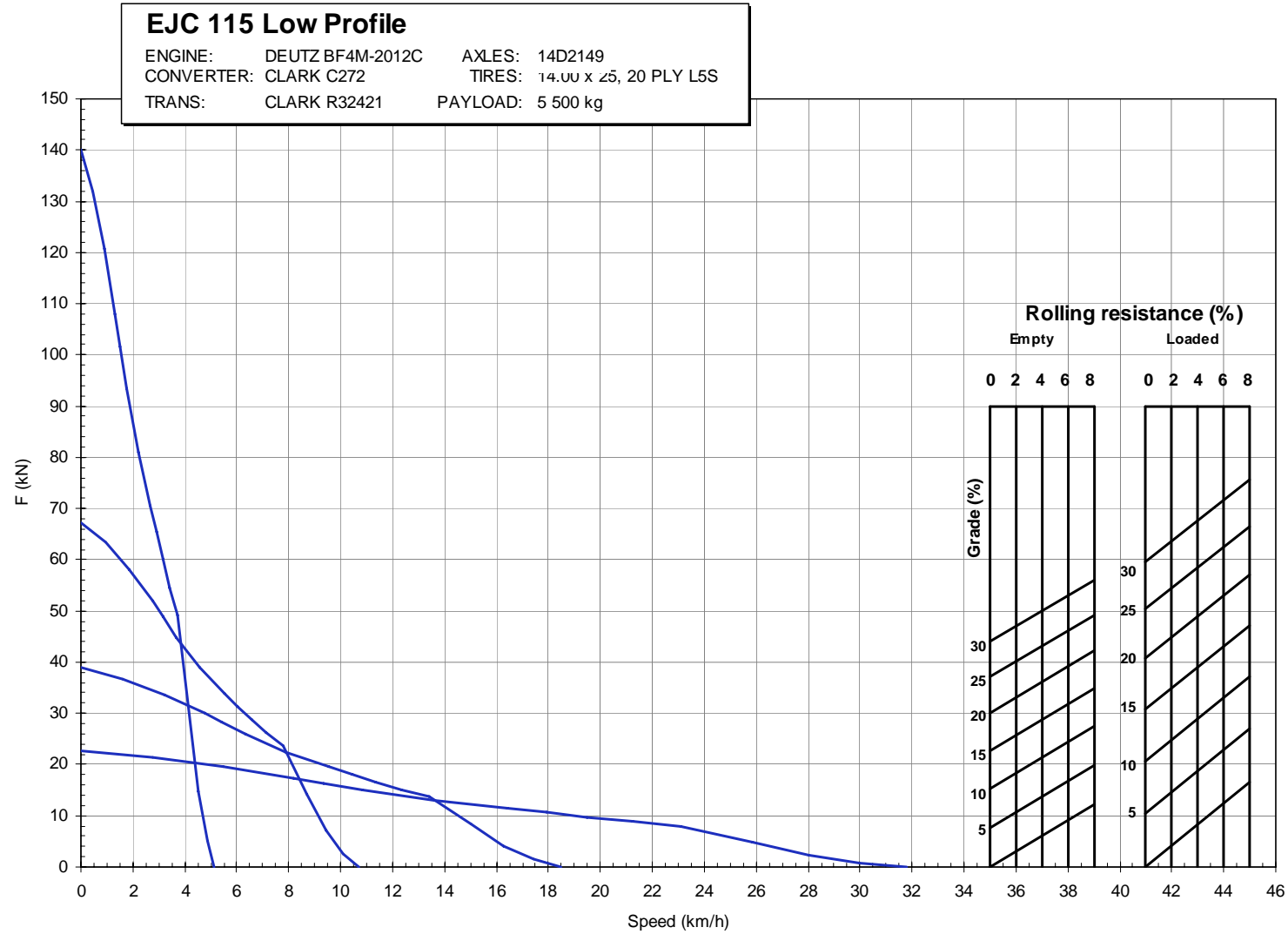

## Tractive Effort Curve (US Units)

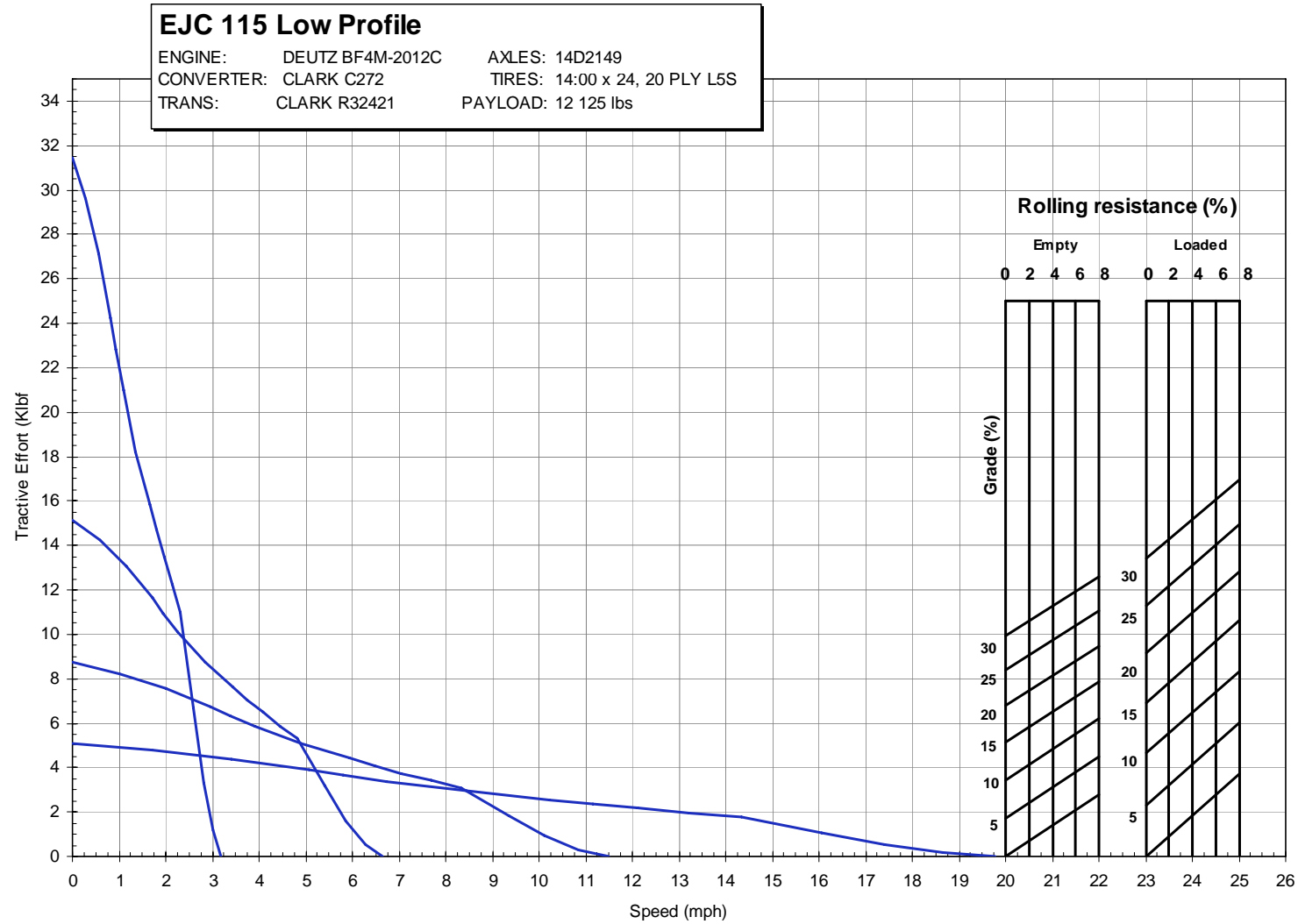

Productivity Curve (Metric Units)

EJC 115 LP PRODUCTIVITY

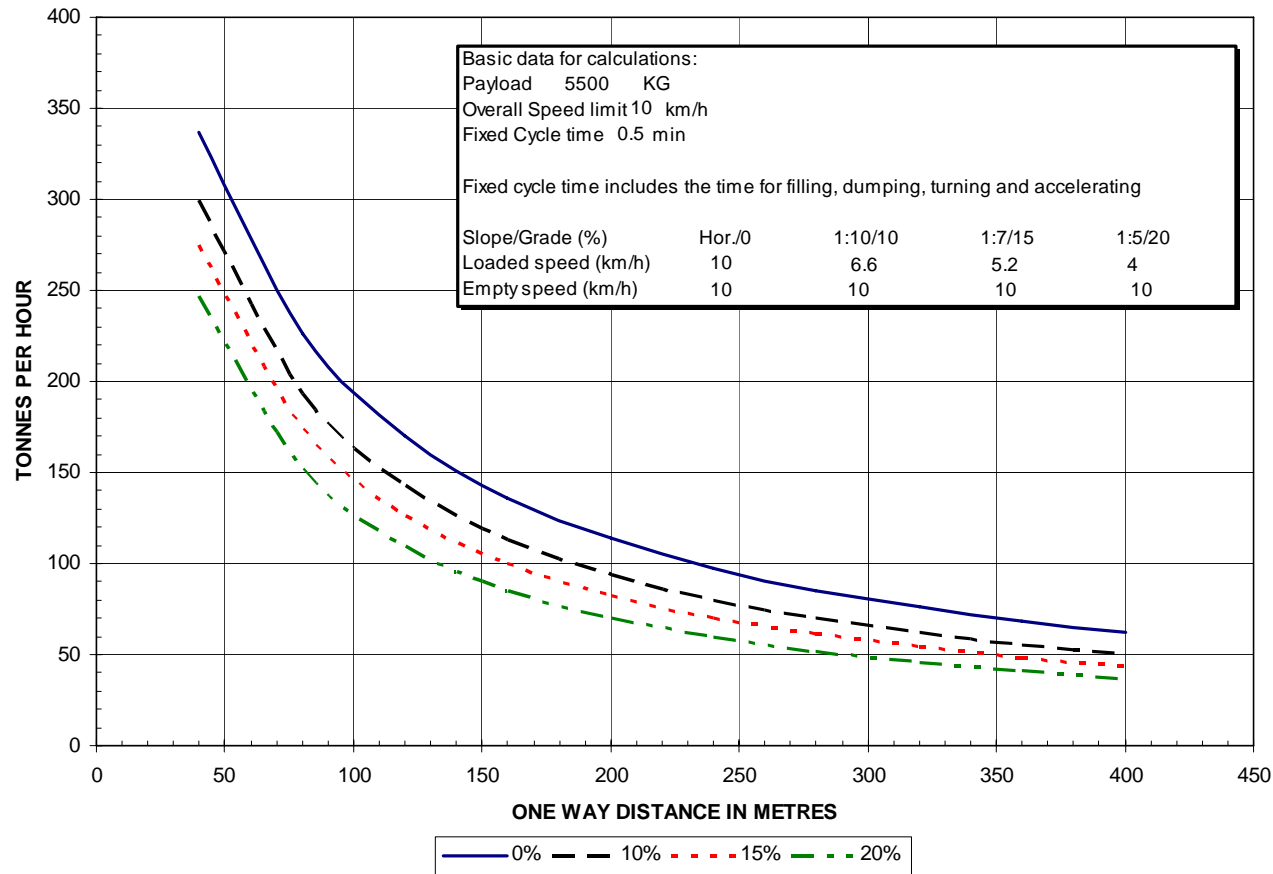

**Productivity Curve (US Units)**

**EJC 115 LP PRODUCTIVITY**

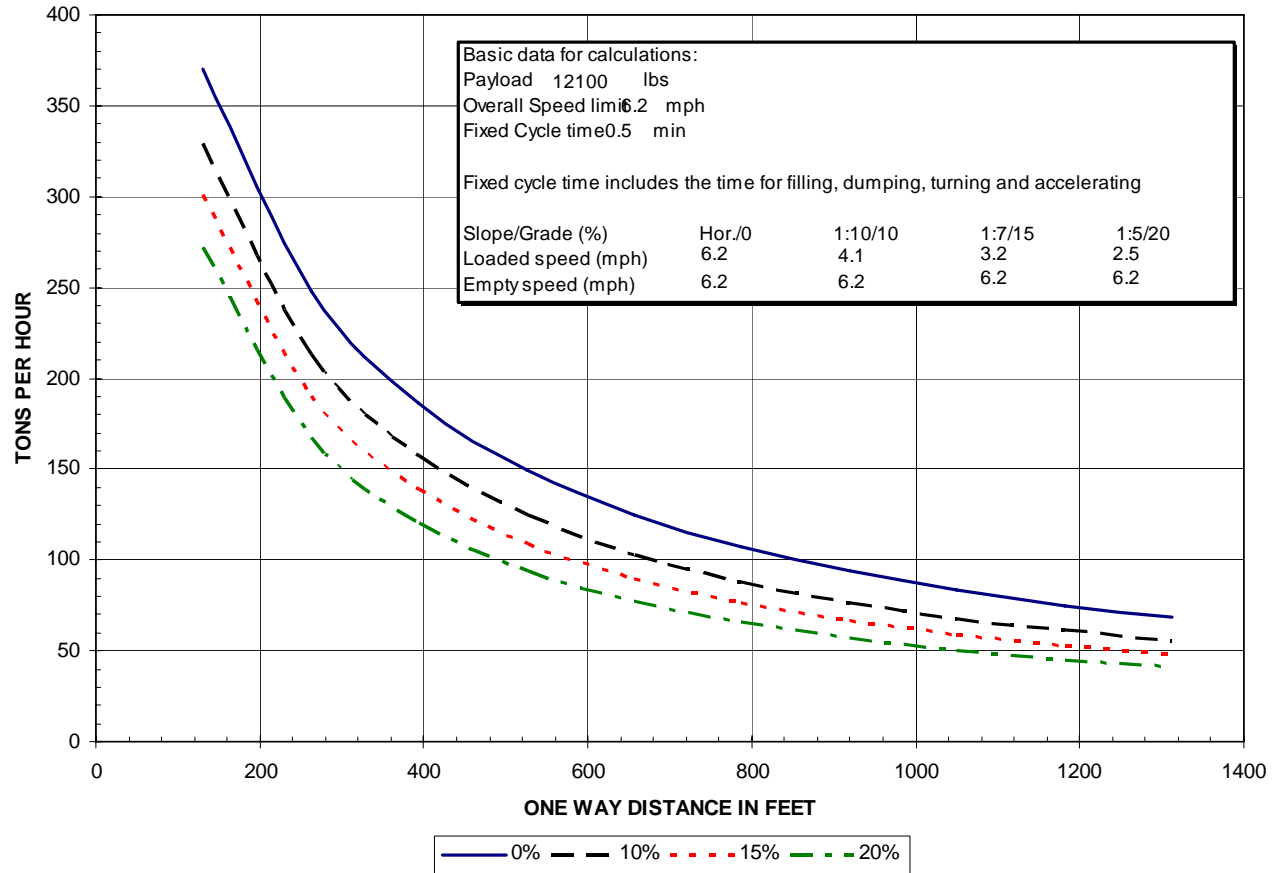



We make it possible